



DEPARTMENT OF THE ARMY
NEW YORK DISTRICT, CORPS OF ENGINEERS
JACOB K. JAVITS FEDERAL BUILDING
NEW YORK, N.Y. 10278-0090

REPLY TO
ATTENTION OF:

DEC 10 2014

Regulatory Branch

**SUBJECT: DEPARTMENT OF THE ARMY PERMIT Number NAN-2012-00090-M5
Originally Issued to New York State Thruway Authority on 25 April 2013 Authorizing
Regulated Work to Facilitate Construction of The New NY Bridge in the Hudson
River between Tarrytown and Nyack, New York**

PERMITTEE:

**New York State Thruway Authority
ATTN: Peter Sanderson, Project Director
555 White Plains Rd, 4th Floor
Tarrytown, NY 10591
(518) 436-2810
(914) 789-3200**

1. Reference is made to:

- a. Subject Department of the Army (DA) permit issued 25 April 2013;
- b. Subject DA Permit Modification #1 issued 24 June 2013;
- c. Subject DA Permit Modification #2 issued 14 January 2014;
- d. Subject DA Permit Modification #3 issued 3 April 2014;
- e. Subject DA Permit Modification #4 issued 17 October 2014;
- f. The subject permittee's permit modification request dated 27 October 2014 for the reconstruction of outfall DR-219 and the placement of new stone rip-rap protection for outfalls DR-219 and DR-319 at the Rockland Landing.

2. In accordance with the provisions of Section 10 of the River & Harbors Act of 1899 (33 USC 403) and Section 404 of the Clean Water Act (33 USC 1344), the New York District of the U.S. Army Corps of Engineers issued the subject Department of the Army permit [Reference 1(a)] on 25 April 2013 to New York State Thruway Authority; issued the first permit modification [Reference 1(b)] on 24 June 2013; issued the second permit modification [Reference 1(c)] on 14 January 2014; issued the third permit modification [Reference 1(d)] on 3 April 2014; and, issued the fourth permit modification [Reference 1(e)] on 17 October 2014.

3. The modified regulated work requested at this time includes the replacement of the existing outfall DR-319 (an 18-inch Reinforced Concrete Pipe [RCP] north of the

SUBJECT: Modification to Department of the Army Permit Number NAN-2012-00090-M5 Issued to the New York State Thruway Authority (New NY Bridge Project)

New York State Thruway) with a 19-inch by 30-inch diameter elliptical RCP, a concrete end section and stone rip-rap outlet protection. The proposed stone fill for DR-319 will impact approximately 202 square feet (sf) of river bottom below the spring high tide line (SHTL).

The existing outfall DR-319 (a 4-foot by 8-foot concrete box culvert south of the New York State Thruway) will not be replaced but stone rip-rap outlet protection will be installed. The proposed stone fill for DR-319 will impact approximately 654 sf of river bottom below the SHTL.

Total fill material to be discharged into waters of the United States below the SHTL is approximately 856 sf (0.02 acre) and 67 cubic yards. Construction activities will be staged and performed in the upland areas, which will be restored upon project completion. The appropriate soil erosion and sediment control measures will be employed during construction.

The two subject outfalls are owned by the New York State Thruway Authority (NYSTA) and are located within a NYSTA right-of-way on the eastern side of River Road in the Village of Grand View-on-Hudson, Rockland County, New York.

4. The following special condition is added to this modification:

- a. The permittee shall undertake the authorized filling activities in a manner aimed at reducing impacts upon the general environment. In addition, the permittee shall not stockpile fill or other materials in a manner conducive to erosion, or in areas likely to cause high turbidity runoff during storm events. All exposed soils shall be re-vegetated in a timely manner to further reduce potential effects. The permittee shall fence off wetlands and other sensitive ecological areas during construction periods to prevent equipment and personnel from entering these areas.

5. Based upon an evaluation of the administrative record supporting the issuance of the subject permit, a review of the permittee's submitted materials in support of their permit modification request [Reference 1(f)], and the incorporation of the aforementioned special condition, the subject permit is hereby modified to include the previously described proposed activities and the Drawing Sheet Numbers H15F-04 Figures 1 to 6, dated 17 January 2014 and titled "The New NY Bridge Unit 15-Rockland Landing" are included as part of the previously authorized permit drawings.

Regulatory Branch

DEC 10 2014

SUBJECT: Modification to Department of the Army Permit Number NAN-2012-00090-M5 Issued to the New York State Thruway Authority (New NY Bridge Project)

6. All other terms, General Conditions, and Special Conditions of the subject issued permit shall remain in effect, including the permit expiration date of 24 MARCH 2019.

7. This modified permit shall be known as Permit Number NAN-2012-00090-M5.

8. This modified subject DA permit shall be available at project offices and regulated work sites.

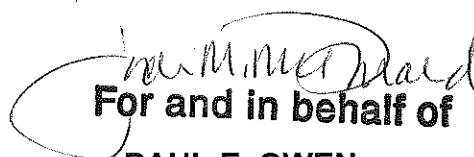

For and in behalf of

**PAUL E. OWEN
Colonel, U.S. Army
Commander**

Enclosures

**CF: (w/encl)
CENAN-OP-R
NYSDEC Region 3 Permit Administrator
Tappan Zee Constructors, LLC**

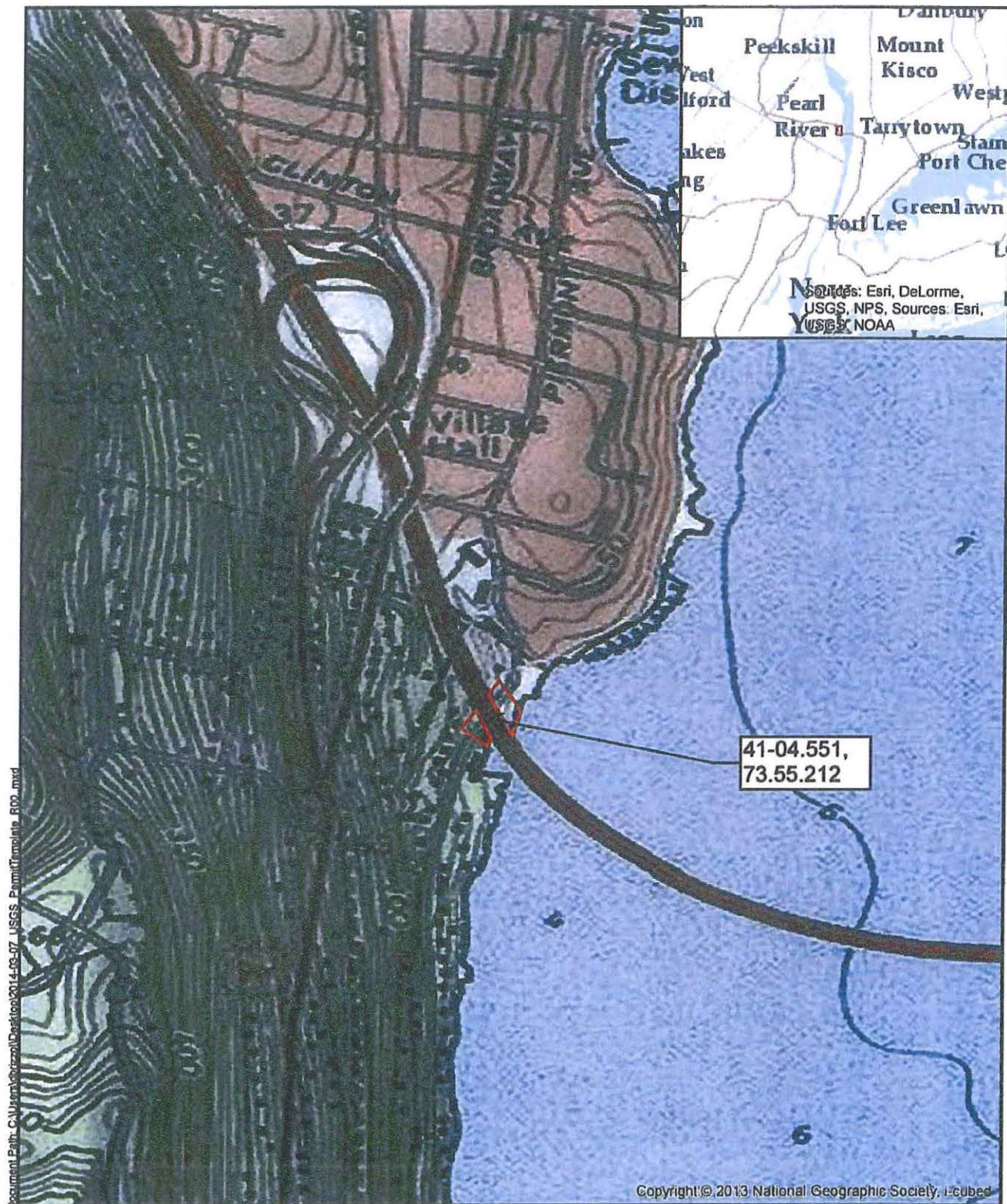
DEC 10 2014



Tappan Zee Hudson River Crossing
Figure 1 - USGS Location Map (Nyack, NY Quad)
Rockland Landing Outfalls

Outfall Areas

N

DOCUMENT TRACKING CODE: H:5F-04



TAPPAN ZEE

CONTRACT NUMBER:
D214134

01/17/14
DRAWING NUMBER:
H15F-04
FIG 1

DATE:11-25-2019 TIME:10:20:18 AM FILE:H156-04-FIGURE

SHEET 2 OF 7

ORIGINATOR: S. SWEETON

ROCK OUTLET PROTECTION TABLE							
FOLLOWS DRAINAGE STRUCTURE NO.	LENGTH 'L' (FT)	WIDTH 'W' (FT)	HEIGHT OF PIPE 'H' (IN)	WIDTH OF PIPE 'W' (IN)	LINING MATERIAL	LINING HEIGHT 'D' (IN)	SIDE SLOPES (H:V)
DR-219	17	19	19	30	LIGHT STONE FILLING	21	2:1
DR-319	26	30	48	96	LIGHT STONE FILLING	27	2:1

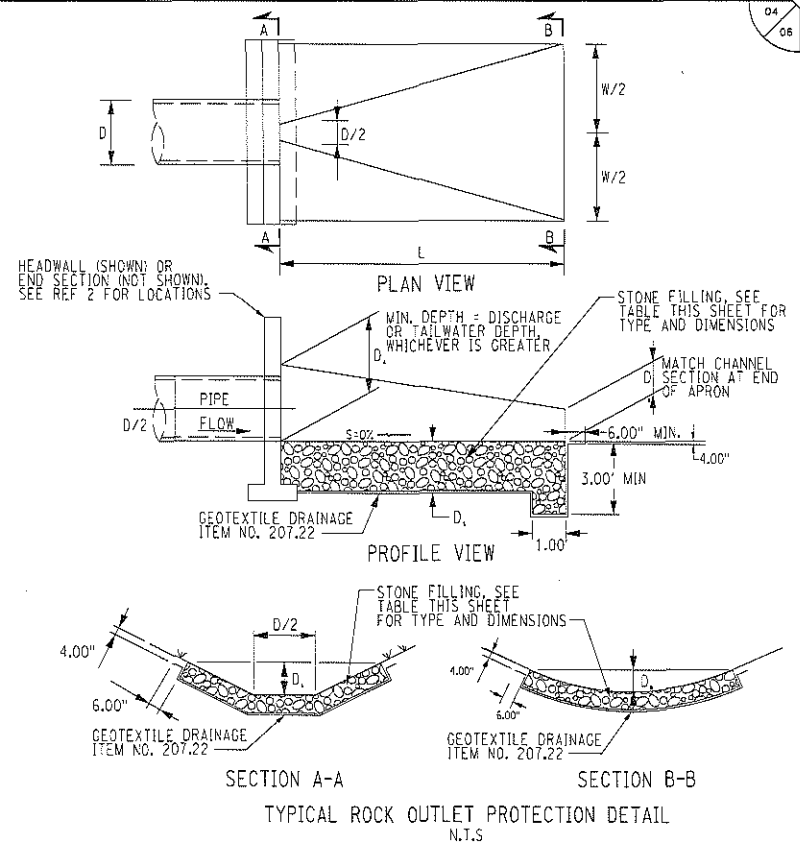

NOTES:

1. FEATURE IS PERMANENT AND SHALL REMAIN AFTER COMPLETION OF CONSTRUCTION.
2. REFER TO NYSDEC NEW YORK STATE STANDARDS AND SPECIFICATIONS FOR EROSION AND SEDIMENT CONTROL FIGURE 5B.16

ALTERED BY:	AFFIXED BY:
SIGNATURE: STAMP:	SIGNATURE: STAMP:

IT IS A VIOLATION OF LAW FOR ANY PERSON, UNLESS THEY ARE ACTING UNDER THE DIRECTION OF A LICENSED PROFESSIONAL ENGINEER, ARCHITECT, LANDSCAPE ARCHITECT, OR LAND SURVEYOR, TO ALTER AN ITEM IN ANY WAY, IF AN ITEM BEARING THE STAMP OF A LICENSED PROFESSIONAL IS ALTERED, THE ALTERING ENGINEER, ARCHITECT, LANDSCAPE ARCHITECT, OR LAND SURVEYOR SHALL STAMP THE DOCUMENT AND INCLUDE THE NOTATION "ALTERED BY" FOLLOWED BY THEIR SIGNATURE, THE DATE OF SUCH ALTERATION, AND A SPECIFIC DESCRIPTION OF THE ALTERATION.

REVISIONS			
DATE	DESCRIPTION	BY	SY
01/17/14	H15F-C4 ISSUED FOR FINAL DESIGN REVIEW	MSM	C



NEW YORK STATE THRUWAY AUTHORITY
DEPARTMENT OF ENGINEERING
200 SOUTHERN BLVD., ALBANY, N.Y. 12209

TITLE OF PROJECT	THE NEW NY BRIDGE
LOCATION OF PROJECT	MILEPOST 14.67 +/- IN ROCKLAND AND WESTCHESTER COUNTIES
TITLE OF DRAWING	UNIT 15--ROCKLAND LANDING OUTFALL DETAILS

CONTRACT NUMBER:	D214134
DATE:	01/17/14
DRAWING NUMBER:	H15F-04 FIG 4



TAPPAN ZEE
GAS PIPELINE, INC.

DATE:11-25-2014 TIME:10:20:32 AM FILE:H15F-04-FIGURE 4

DEC 10 2014

05
06

USACE FILE NO. 2012-00090-M5

DESIGNED BY: S. SWEETON
CHECKED BY: M. SHAN
DATE: 01/17/14

SHEET 6 OF 7

DESIGNED BY: S. SWEETON
CHECKED BY: M. SHAN
DATE: 01/17/14

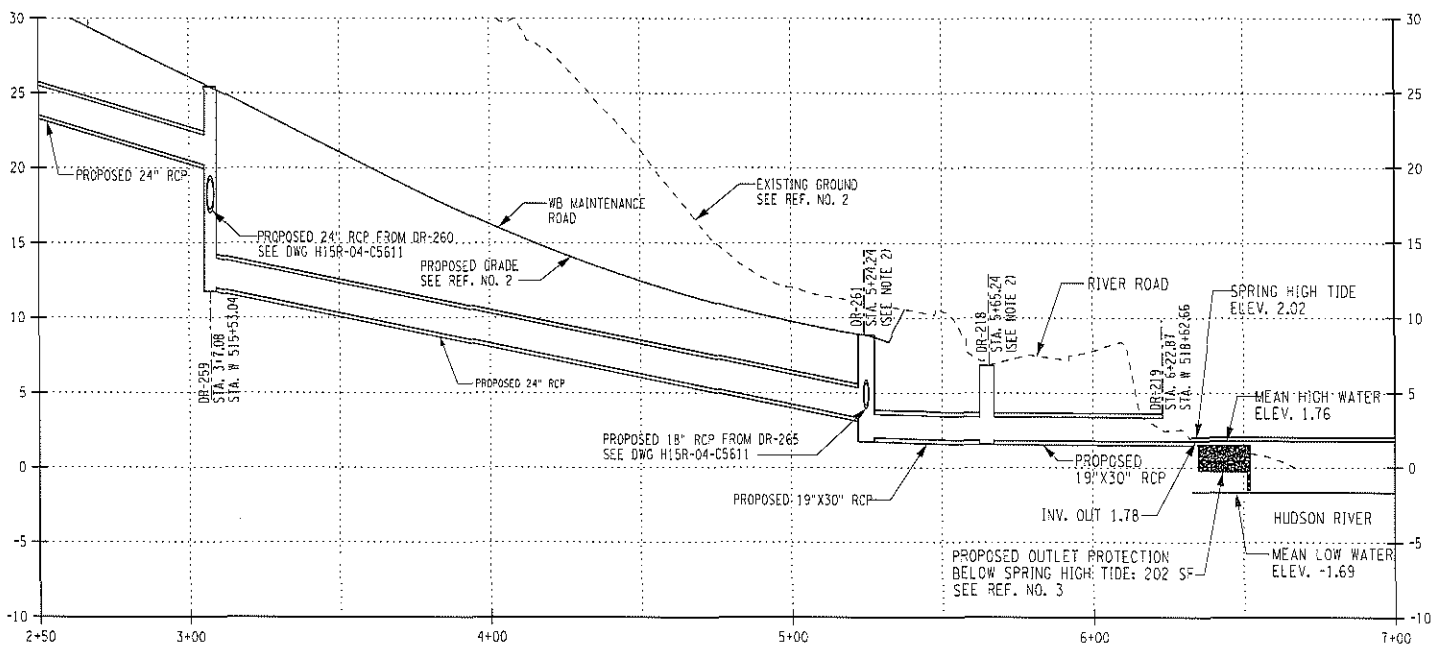

DRAINAGE PROFILE (DR-219 OUTLET TO HUDSON RIVER)
STA 2+50 TO 7+00

REFERENCES

- REF. NO. DRAWING TITLE
- 1 DRAINAGE TABLES (UNIT 15)
- 2 GRADING PLANS (UNIT 15)
- 3 OUTFALL DETAILS

UNLESS NOTED OTHERWISE, ALL REFERENCED DRAWINGS ARE WITHIN THIS DESIGN PACKAGE.

IT IS A VIOLATION OF LAW FOR ANY PERSON, UNLESS THEY ARE ACTING UNDER THE DIRECTION OF A LICENSED PROFESSIONAL ENGINEER, ARCHITECT, LANDSCAPE ARCHITECT, OR LAND SURVEYOR, TO ALTER AN ITEM IN ANY WAY, IF AN ITEM BEARING THE STAMP OF A LICENSED PROFESSIONAL IS ALTERED, THE ALTERING ENGINEER, ARCHITECT, LANDSCAPE ARCHITECT, OR LAND SURVEYOR SHALL STAMP THE DOCUMENT AND INCLUDE THE NOTATION "ALTERED BY" FOLLOWED BY THEIR SIGNATURE, THE DATE OF SUCH ALTERATION, AND A SPECIFIC DESCRIPTION OF THE ALTERATION.

REVISIONS

DATE	DESCRIPTION	BY	SYTA
01/17/14	H15F-04 ISSUED FOR FINAL DESIGN REVIEW	MSM	C



NEW YORK STATE THRUWAY AUTHORITY
DEPARTMENT OF ENGINEERING
200 SOUTHERN BLVD., ALBANY, N.Y. 12209



TITLE OF PROJECT: THE NEW NY BRIDGES
LOCATION OF PROJECT: MILEPOST 14.87 +/- IN ROCKLAND AND WESTCHESTER COUNTIES
TITLE OF DRAWING: UNIT 15-ROCKLAND LANDING DR-219 PROFILE

CONTRACT NUMBER: D214134
DATE: 01/17/14
DRAWING NUMBER: H15F-04
FIG 5

DEC 10 2014

DOCUMENT TRACKING CODE: H15F-04

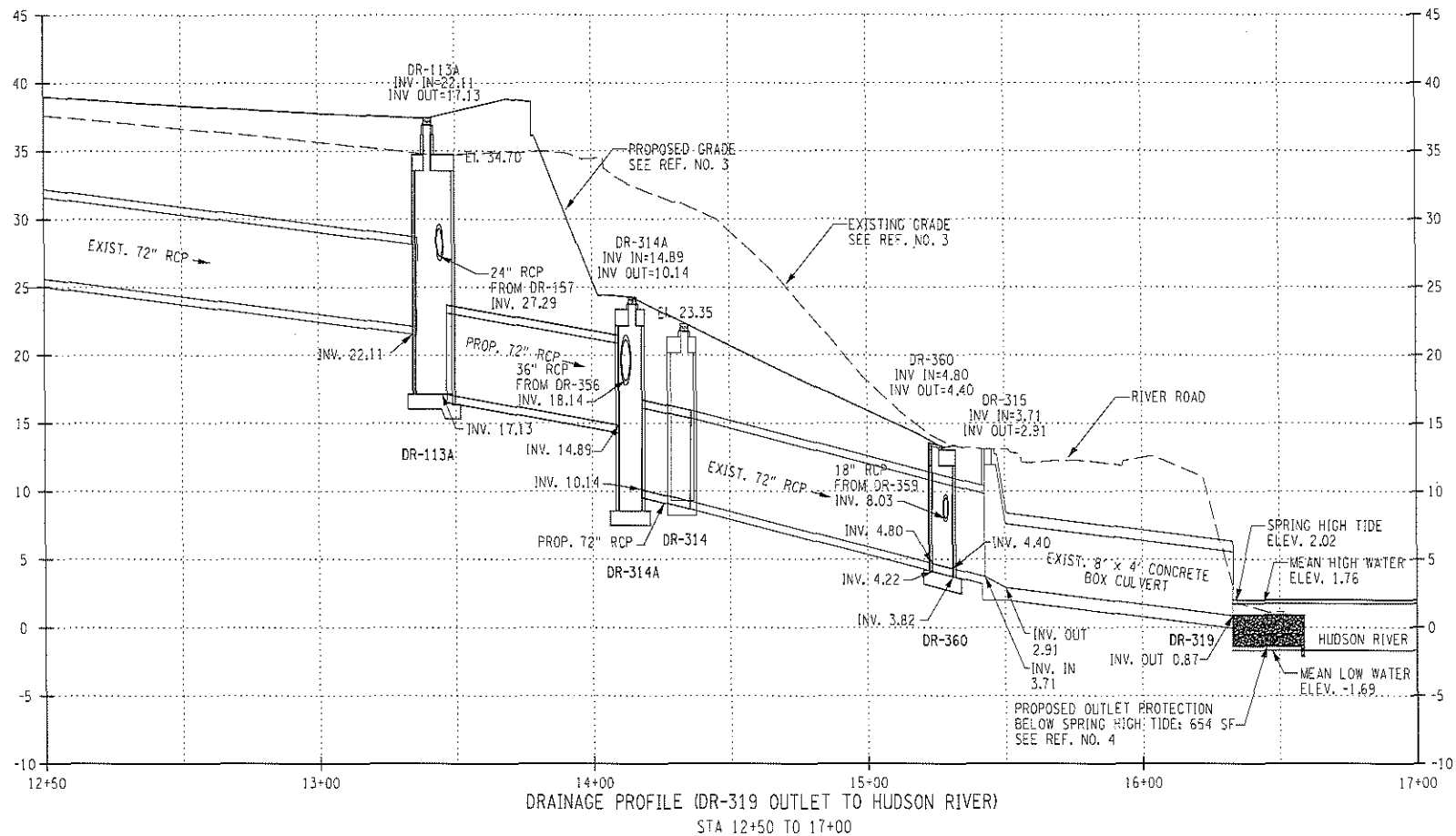

ALTERED BY:	AFFIRMED BY:
DESIGNED BY:	SIGNATURE:
STAMP:	STAMP:

REFERENCES

- REF. NO. DRAWING TITLE
- 1 DRAINAGE TABLES (UNIT 15)
 - 2 DRAINAGE DETAILS (UNIT 15)
 - 3 GRADING PLANS (UNIT 15)
 - 4 OUTFALL DETAILS

UNLESS NOTED OTHERWISE, ALL REFERENCED DRAWINGS ARE WITHIN THIS DESIGN PACKAGE.

IT IS A VIOLATION OF LAW FOR ANY PERSON, UNLESS THEY ARE ACTING UNDER THE DIRECTION OF A LICENSED PROFESSIONAL ENGINEER, ARCHITECT, LANDSCAPE ARCHITECT OR LAND SURVEYOR, TO ALTER AN ITEM IN ANY WAY. IF AN ITEM BEARING THE STAMP OF A LICENSED PROFESSIONAL IS ALTERED, THE ALTERING ENGINEER, ARCHITECT, LANDSCAPE ARCHITECT, OR LAND SURVEYOR SHALL STAMP THE DOCUMENT AND INCLUDE THE NOTATION "ALTERED BY" FOLLOWED BY THEIR SIGNATURE, THE DATE OF SUCH ALTERATION, AND A SPECIFIC DESCRIPTION OF THE ALTERATION.

REVISIONS

DATE	DESCRIPTION	BY	SYM.
01/17/14	H15F-04 ISSUED FOR FINAL DESIGN REVIEW	BC	C



NEW YORK STATE THRUWAY AUTHORITY
DEPARTMENT OF ENGINEERING
200 SOUTHERN BLVD., ALBANY, N.Y. 12209



TITLE OF PROJECT
THE NEW NY BRIDGE
LOCATION OF PROJECT
MILEPOST 14.67 +/- IN
ROCKLAND AND WESTCHESTER COUNTIES
TITLE OF DRAWING
UNIT 15-ROCKLAND LANDING
DR-319 PROFILE

CONTRACT NUMBER
D214134
DATE
01/17/14
DRAWING NUMBER
H15F-04
PAGE 6